

CA 5070, 50100 Curtain Wall Framing

Application/ Intended Use

This light weight curtain wall can be used in multiple applications, including; entrance framing and windows, storefronts. Incorporate with the CA 120 series of casements and awnings when natural ventilation is required. Compatible with all other Cahill products.

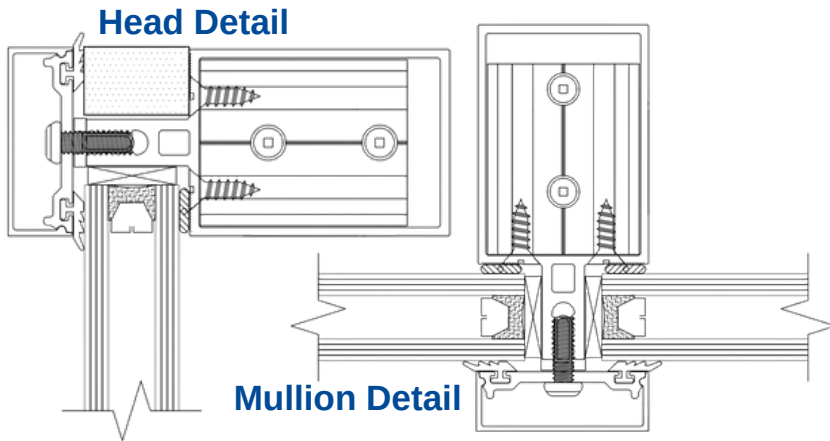

Features

- CA 50100 offers thermally broken curtain wall frame design
- 50.8mm exterior and interior sight lines
- 19mm cap depth
- Curtain wall stick construction for seamless look
- Can be used for full height construction
- Rain screen designed
- Multiple Back Section Depths:
 - ▶ CA50100 101.6mm deep back section
 - ▶ CA5070 70mm deep back section
- Custom options available

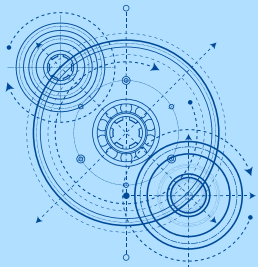

Ratings

- Tested based on the following: ASTM-E283, ASTM-E547, ASTM-E331 AND ASTM-E330
- The following results are with reference to CAN/CSA A440-00:
 - ▶ Air Tightness (Fixed)
 - ▶ Water Tightness (B=7)
 - ▶ Wind Load Resistance (C=S)
 - ▶ Condensation Resistance I= 63