

CA 720 Terrace Door

Application/ Intended Use

A fully thermally broken and rain screen designed terrace door that maximizes balcony space by swinging inward.

Head and Sill Detail

Jamb Detail

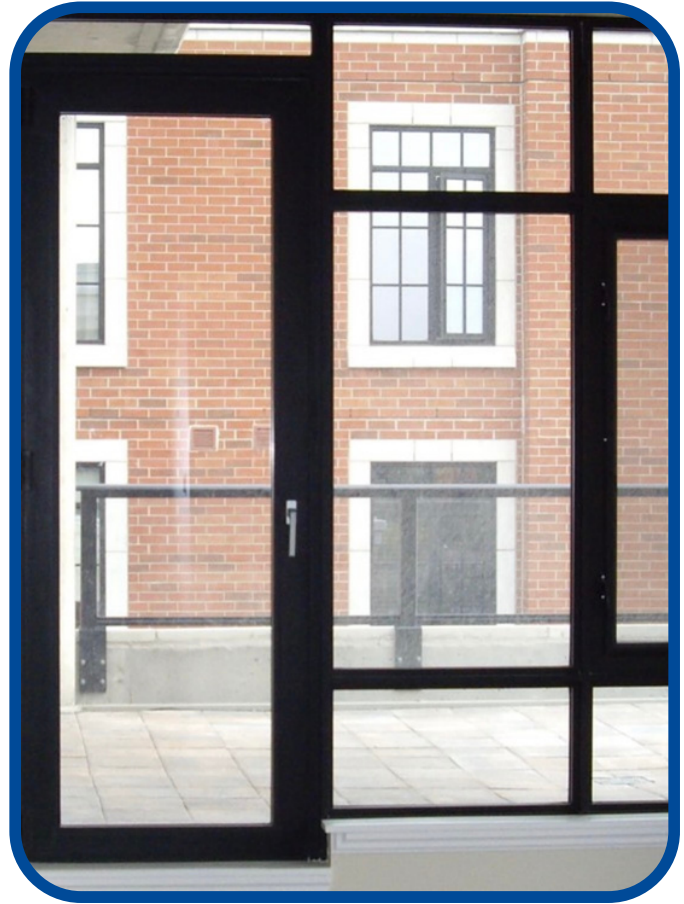
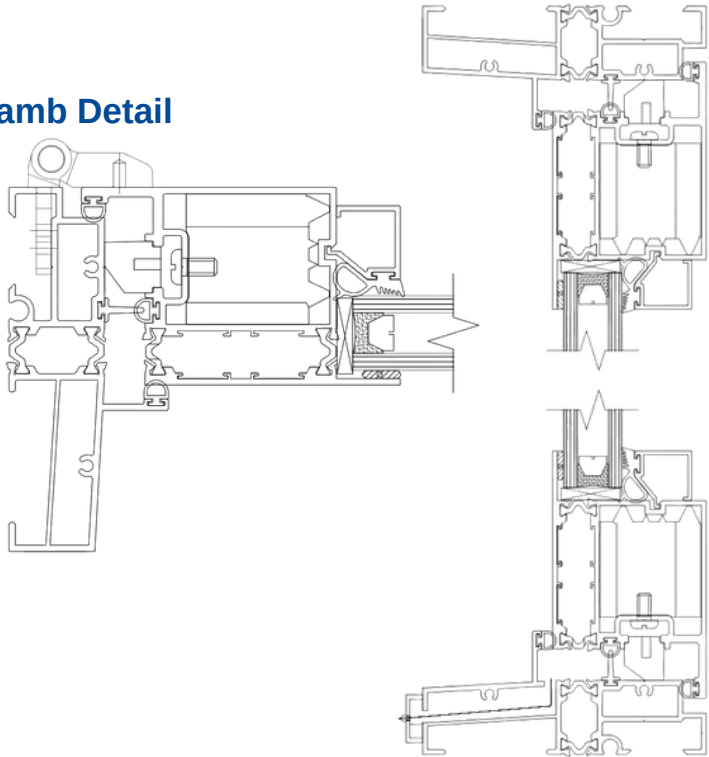

Features

- Conjoined thermal break allows for maximum insulation effect
- Open view glazing style for maximized entry of natural light
- Flat wall design with maximum frame depth of 114mm