

CA 420 Commercial Door

Application/ Intended Use

Heavy duty, thermally broken entrance door design. Compatible with the CA 50 and CA 63 curtain wall series systems.

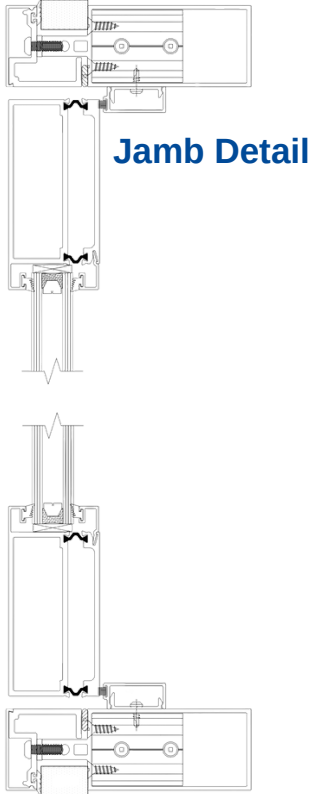

Features

- Manufactured to fit door opening
- Top rail 117mm
- Stiles 117mm
- Bottom rail 117mm
- Extrusions 6063 T5 or T6 wall thickness 3mm
- Available with 133mm mid rail, 169mm stiles, 194mm top or bottom rail or both